

## KPB

Joining bracket

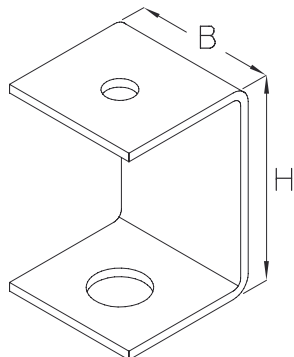

Hot-dip galvanized, according to BS 729 (DIN EN ISO 1461)

Product	H	B	L	t	G
KPB F	60 mm	40 mm	40 mm	2,50 mm	0,11 kg

**H** : Height  
**B** : Width  
**L** : Length  
**t** : Material thickness  
**G** : Weight

## DETAILS / APPLICATIONS

