

# TKLA 18

Beam clamp

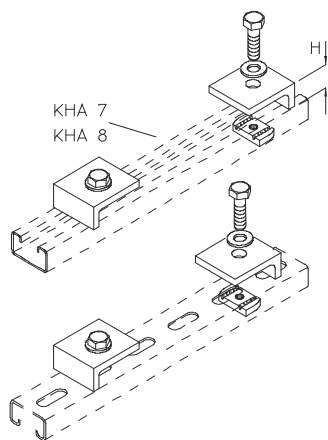

Hot-dip galvanized, according to BS 729 (DIN EN ISO 1461)

Product	H	D	G
TKLA 18-10F	10 mm	6 - 10 mm	0,52 kg
Accessories included:			
2x SES 10F 2x US 10x21F 2x AM18 M10F	Hexagon head bolt, DIN 933 Square washer, DIN 9021 Channel nut, A 41/ KHA 41/ KHAL 41		
TKLA 18-15F	15 mm	11 - 15 mm	0,55 kg
Accessories included:			
2x SES 10F 2x US 10x21F 2x AM18 M10F	Hexagon head bolt, DIN 933 Square washer, DIN 9021 Channel nut, A 41/ KHA 41/ KHAL 41		
TKLA 18-20F	20 mm	16 - 20 mm	0,58 kg
Accessories included:			
2x SES 10F 2x US 10x21F 2x AM18 M10F	Hexagon head bolt, DIN 933 Square washer, DIN 9021 Channel nut, A 41/ KHA 41/ KHAL 41		
TKLA 18-25F	25 mm	21 - 25 mm	0,60 kg
Accessories included:			
2x SES 10F 2x US 10x21F 2x AM18 M10F	Hexagon head bolt, DIN 933 Square washer, DIN 9021 Channel nut, A 41/ KHA 41/ KHAL 41		
TKLA 18-30F	30 mm	26 - 30 mm	0,63 kg
Accessories included:			
2x SES 10F 2x US 10x21F 2x AM18 M10F	Hexagon head bolt, DIN 933 Square washer, DIN 9021 Channel nut, A 41/ KHA 41/ KHAL 41		
TKLA 18-35F	35 mm	31 - 35 mm	0,66 kg
Accessories included:			
2x SES 10F 2x US 10x21F 2x AM18 M10F	Hexagon head bolt, DIN 933 Square washer, DIN 9021 Channel nut, A 41/ KHA 41/ KHAL 41		



Product	H	D	G
TKLA 18-40F	40 mm	36 - 40 mm	0,69 kg
Accessories included:			
2x SES 10F	Hexagon head bolt, DIN 933		
2x US 10x21F	Square washer, DIN 9021		
2x AM18 M10F	Channel nut, A 41/ KHA 41/ KHAL 41		

**H** : Height  
**D** : Diameter  
**G** : Weight

## DETAILS / APPLICATIONS

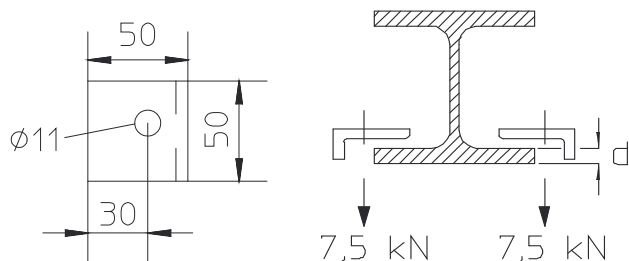

## OPTIONAL ACCESSORIES

KHA 7, KHA 8

