

BL 7

Corner angle

Wall bracket for mounting bracket holders KHI on the wall.

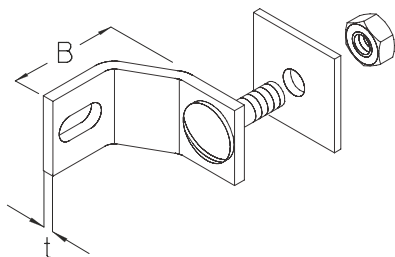

Hot-dip galvanized, according to BS 729 (DIN EN ISO 1461)

Product	H	B	t	G
BL 7F	50 mm	65 mm	5 mm	0,30 kg
Incl.:				
1x FRS 12X30F		Round-head screw with short square, DIN 603		
1x SEM 12F		Hexagon-nut, DIN 934		
1x RUS 50-L13F		Square washer		

H : Height

B : Width

t : Material thickness

G : Weight

DETAILS / APPLICATIONS

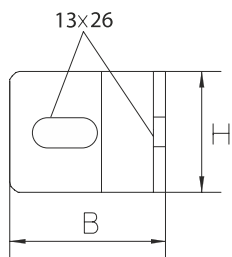

OPTIONAL ACCESSORIES

SD

