

## KDI

Bracket support, heavy, profile I80

Ceiling bracket support, heavy building class, made of profile I 80, with continuously elongated hole perforation in bars, with welded head plate, certified according to DIN EN 61357.

$F_D/P$ : coefficient for calculation of the dowel load  $F_D$  with effective bracket load  $P$  respectively the sum of effective bracket loads. The material thickness indicates the thickness of the head plate.



BAWA  
GERM  
TYPE  
APPRO



Hot-dip galvanized, according to BS 729 (DIN EN ISO 1461)

Product	L	t	G
KDI 02F	200 mm	6 mm	1,87 kg
KDI 03F	300 mm	6 mm	2,40 kg
KDI 04F	400 mm	6 mm	3,00 kg
KDI 05F	500 mm	6 mm	3,60 kg
KDI 06F	600 mm	6 mm	4,20 kg
KDI 07F	700 mm	6 mm	4,80 kg
KDI 08F	800 mm	6 mm	5,40 kg
KDI 09F	900 mm	6 mm	6,00 kg
KDI 10F	1000 mm	6 mm	6,60 kg
KDI 11F	1100 mm	8 mm	7,39 kg
KDI 12F	1200 mm	8 mm	7,97 kg
KDI 13F	1300 mm	8 mm	8,56 kg
KDI 14F	1400 mm	8 mm	9,14 kg
KDI 15F	1500 mm	8 mm	9,73 kg
KDI 16F	1600 mm	8 mm	10,31 kg
KDI 17F	1700 mm	8 mm	10,90 kg
KDI 18F	1800 mm	8 mm	11,48 kg
KDI 19F	1900 mm	8 mm	12,20 kg
KDI 20F	2000 mm	8 mm	12,60 kg
KDI 21F	2100 mm	8 mm	13,20 kg
KDI 22F	2200 mm	8 mm	13,90 kg

Page 1



Product	L	t	G
KDI 23F	2300 mm	8 mm	14,50 kg
KDI 24F	2400 mm	8 mm	15,20 kg
KDI 25F	2500 mm	8 mm	15,60 kg
KDI 26F	2600 mm	8 mm	16,24 kg
KDI 27F	2700 mm	8 mm	16,75 kg
KDI 28F	2800 mm	8 mm	17,33 kg
KDI 29F	2900 mm	8 mm	17,92 kg
KDI 30F	3000 mm	8 mm	18,50 kg

**L** : Length  
**t** : Material thickness  
**G** : Weight

## DETAILS / APPLICATIONS

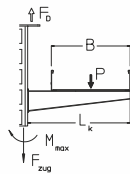
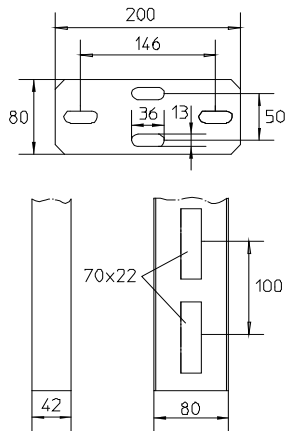

L ≤ 1000: M<sub>max</sub> = 1600 Nm  
 L > 1000: M<sub>max</sub> = 2200 Nm  
 F<sub>zug</sub> = 20 kN

B	Lk	Pmax L>1000 kN	Pmax L<1000 KN	F <sub>D</sub> P
mm	mm			
100	120	20,0	14,5	1,3
200	220	13,8	10,0	1,6
300	320	10,5	7,6	1,9
400	420	8,5	6,2	2,3
500	520	7,1	5,2	2,6
600	620	6,1	4,4	3,0

## OPTIONAL ACCESSORIES

KT, KTS, KTSS, SD, SI



TÜV certified



Certified according to Det Norske Veritas (DNV) and Germanischer Lloyd (GL)

